

UN-2-76-SGV

2 Sided Unitised Vertical Structurally Glazed Curtain Walling System

The system currently offers frames for three types of glazed units, a 28mm thick double glazed fixed light unit, a 6mm single glazed spandrel panel and a 28mm double glazed top hung casement. Fixed double glazing incorporates flush edged double glazing units whilst the top hung windows utilise double glazing units that have stepped edges to enable clean and continuous sight lines whilst providing high levels of performance. All fixed double glazed units MUST be dual sealed with a P.I.B. Primary Seal and a secondary seal.

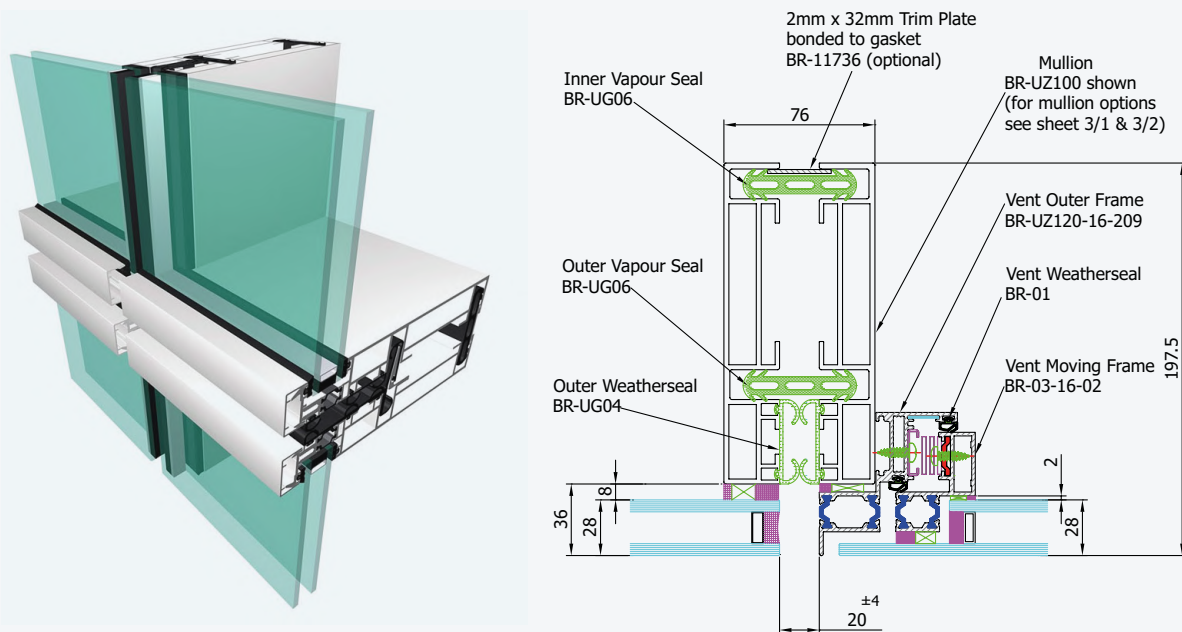

UN-2-76-SGV

System Performance



SIZE

- Total frame profile widths only 76mm.
- Profile depths vary according to project requirements, such as 127mm or 161.5mm.



DESIGN

- Designed specifically for the Gulf climatic conditions.
- Designed to perform at windloads in excess of 3.5 kPa.
- Designed to meet the CWCT standards so meets BS:EN, ASTM, AAMA specifications.



PERFORMANCE

- Thermally Broken frameless outward opening vent panels can be incorporated.
- Extruded gaskets seal between frames to provide secure weather resistance.
- Thermal Break frameless outward opening vent panels can be incorporated.



INSTALLATION

- Allows rapid on-site installation of factory prefabricated panels usually without the need for external access to the building.
- Horizontal cappings can be formed as feature fins or sun shade blades.

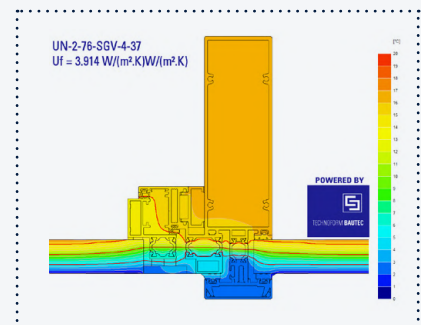

Isotherm Diagram

DISCOVER
MORE ON OUR
WEBSITE

